

Tolerance is
± .2MM
unless
otherwise
specified.

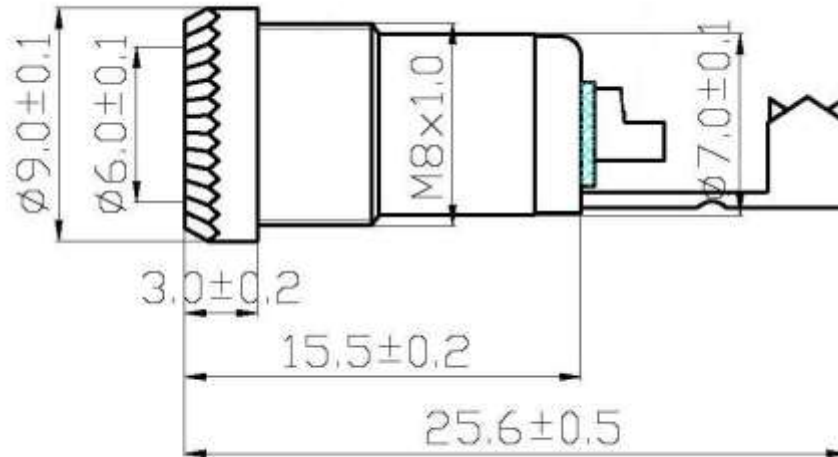

Contact Resistance: ≤ 30m

Insulation Resistance: ≤ 100mm

Withstand Voltage: DC 100V

Current Rating: 100V/3~5A

Operating Temp: -30°C ~ 60°C

Mating Receptacle Options for 205INL

- 1. ANY 205 STYLE PLUG (2.1 x 5.5mm)

PART NO.	205INL
DATE	12.11.2014
APPROVAL	CB
UNIT	mm
REV	0

PART TITLE	DC Plug 2.1mm Inline Cable Mount, Octagonal
------------	---



CONDOR ELECTRONICS, INC.
T: 408-745-7141 F: 408-745-0439
990 San Antonio Road
Palo Alto, CA 94303 USA
sales@condorelectronics.net