

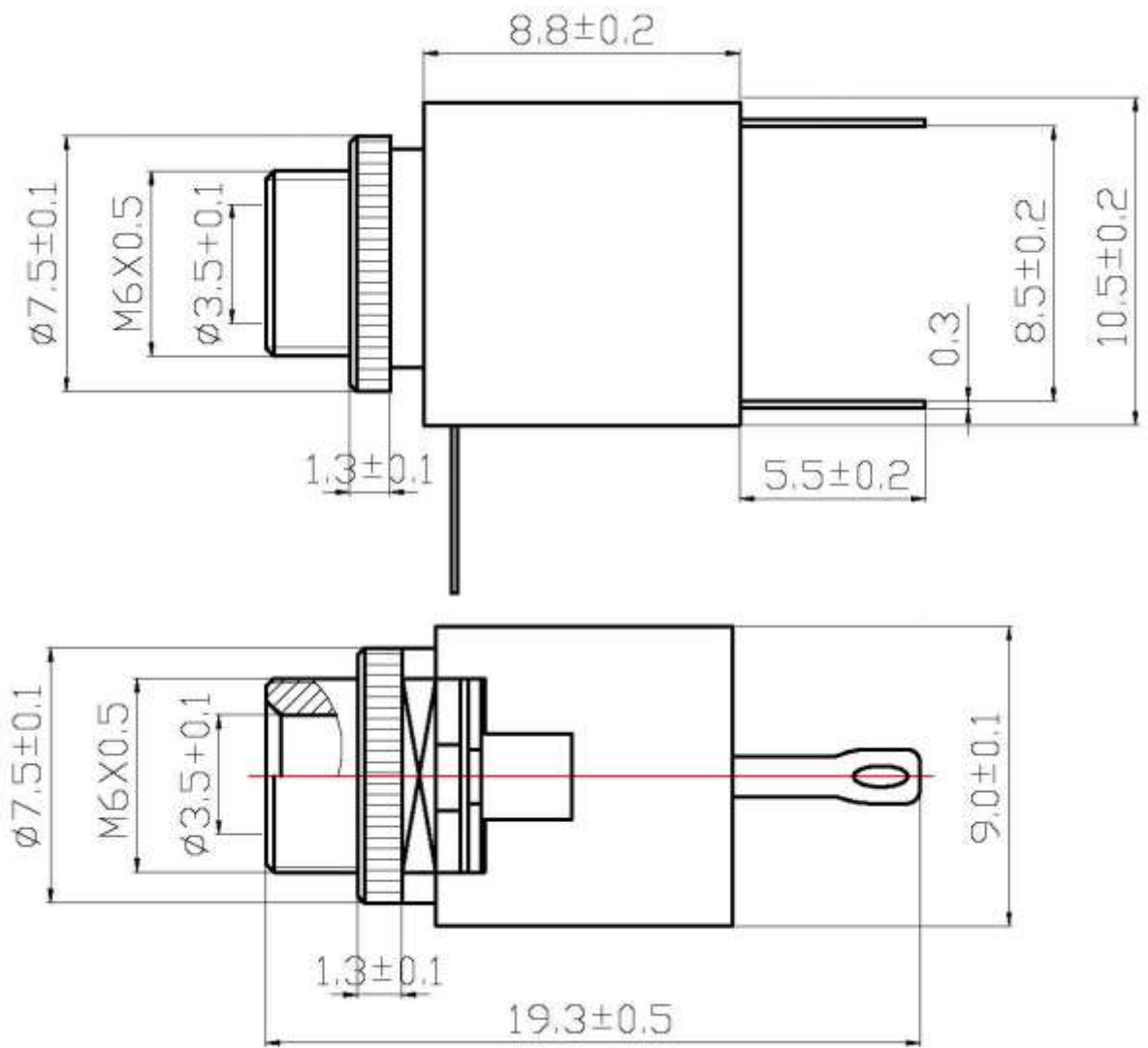

Tolerance is  
± .2MM  
unless  
otherwise  
specified.



**Mating Receptacle Options for HTJ-035**

- 1. ANY 202 STYLE PLUG (3.5mm)

<b>PART NO.</b>	<b>HTJ-035</b>
<b>DATE</b>	<b>12.11.2014</b>
<b>APPROVAL</b>	<b>CB</b>
<b>UNIT</b>	<b>mm</b>
<b>REV</b>	<b>0</b>

<b>PART TITLE</b>	<b>DC 3.5mm Male Chassis Mount Receptacle</b>
-------------------	---



**CONDOR ELECTRONICS, INC.**  
 T: 408-745-7141 F: 408-745-0439  
 990 San Antonio Road  
 Palo Alto, CA 94303 USA  
[sales@condorelectronics.net](mailto:sales@condorelectronics.net)