

Tolerance is  
± .3MM  
unless  
otherwise  
specified.

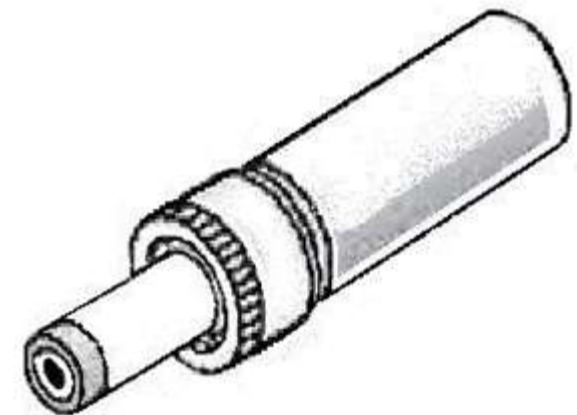
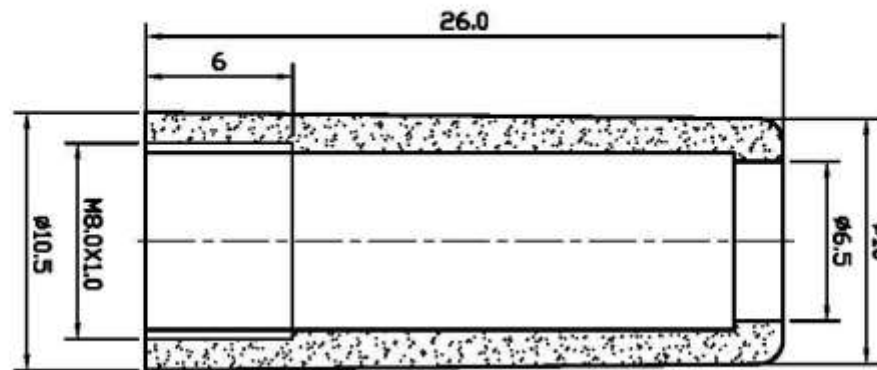

PLUG SIZE: 2.1 x 5.5 x 12MM

RATING: 18V 2A

APPROVALS: ROHS

<b>PART TITLE</b>	DC Locking Plug, 2.1 x 5.5 x 12mm, Hard Plastic Shell
-------------------	--

<b>PART NO.</b>	S761K
<b>DATE</b>	12.11.2014
<b>APPROVAL</b>	CB
<b>UNIT</b>	mm
<b>REV</b>	0



**CONDOR ELECTRONICS, INC.**  
T: 408-745-7141 F: 408-745-0439  
780 Montague Expy. Ste. 406  
San Jose, CA 95131 USA  
sales@condorelectronics.net

<b>Mating Receptacle Options for S761K</b>
1. 22HP038A-2.5L - Chassis Mount